

REVISIONS		
DATE	NAME	LIC. NO.

BLOCK 353 LOT 4

SCALE: 1"=50'



FIRST FLOOR

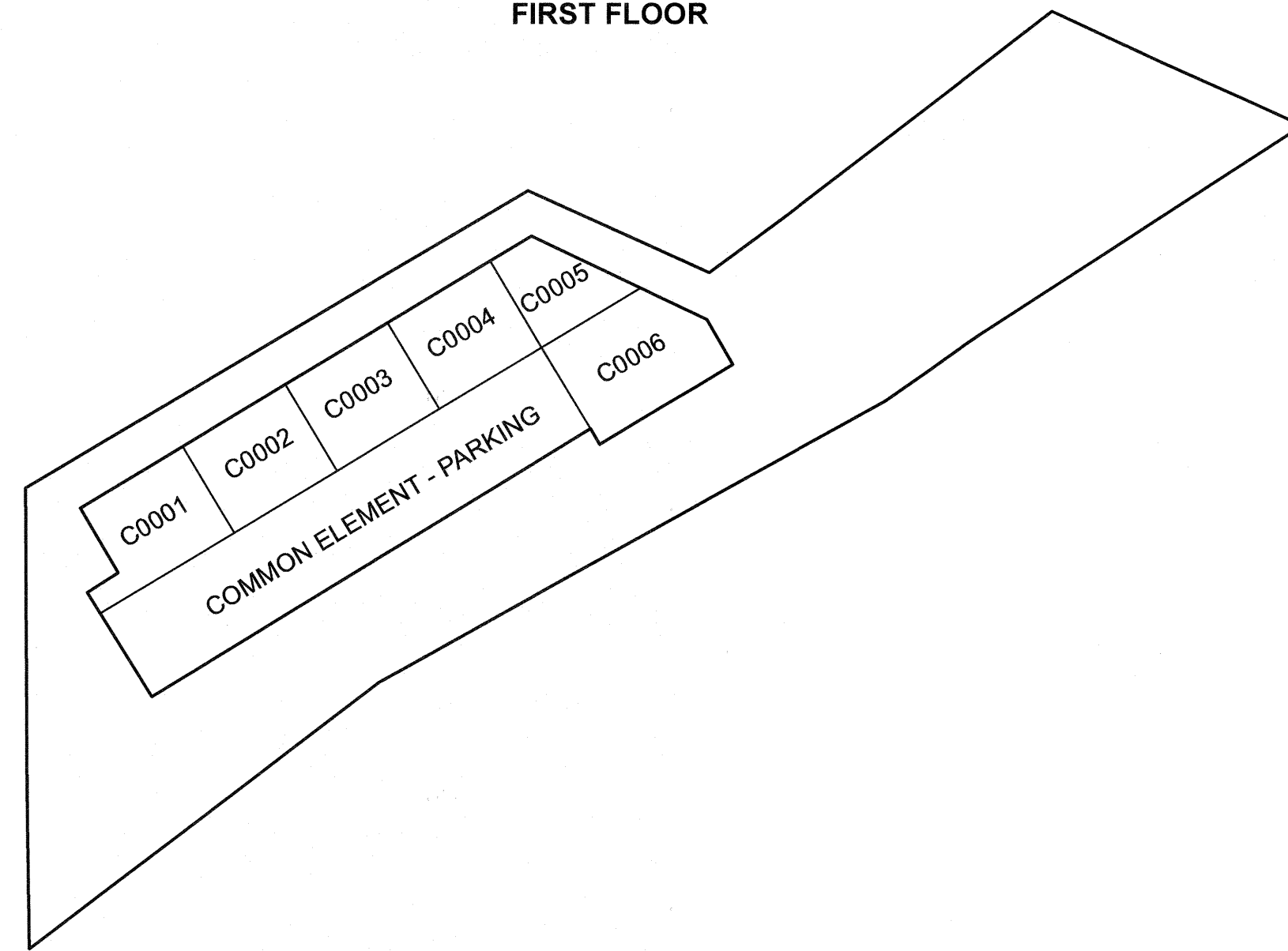

SECOND AND THIRD FLOOR

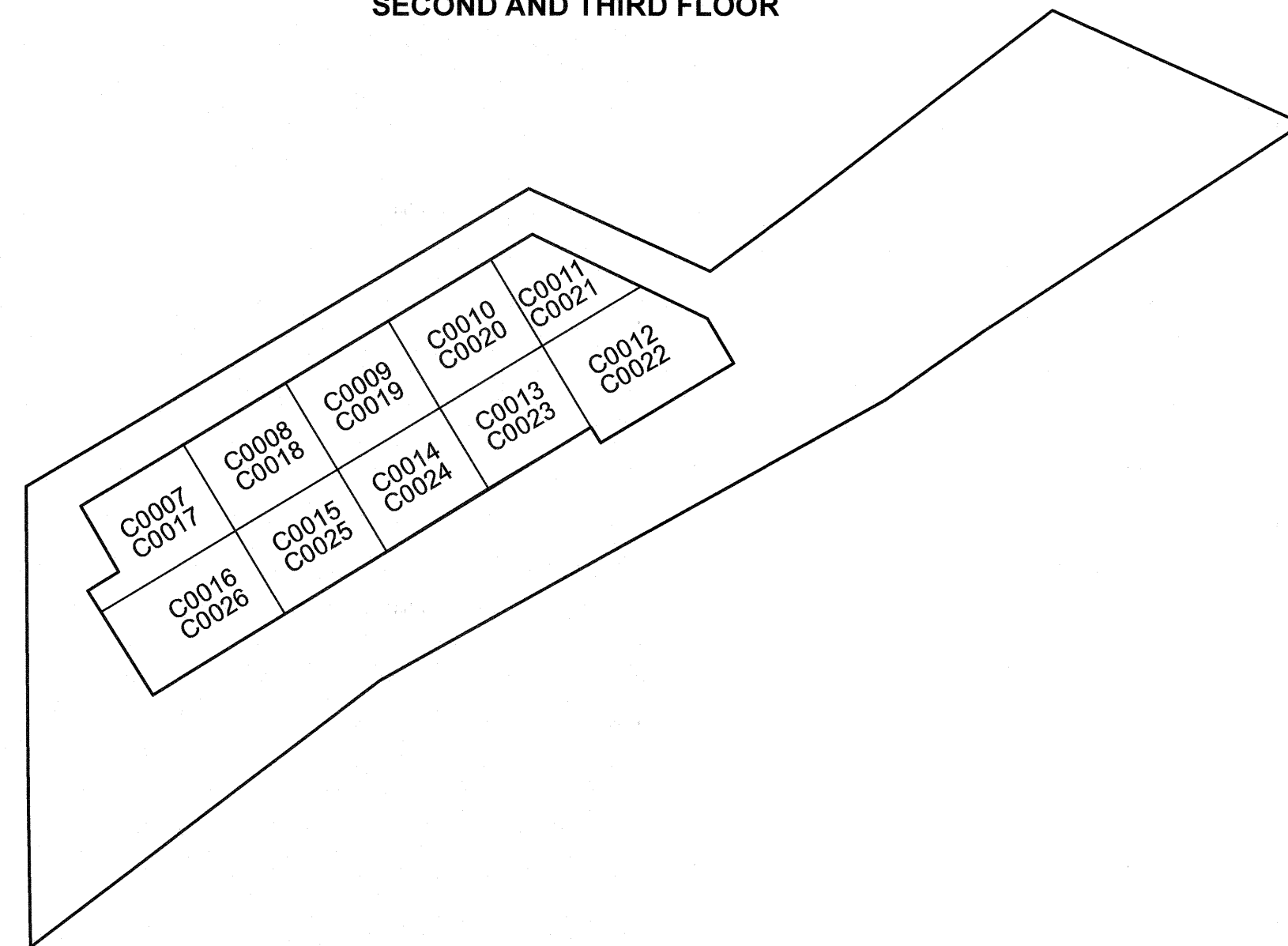

FOURTH FLOOR

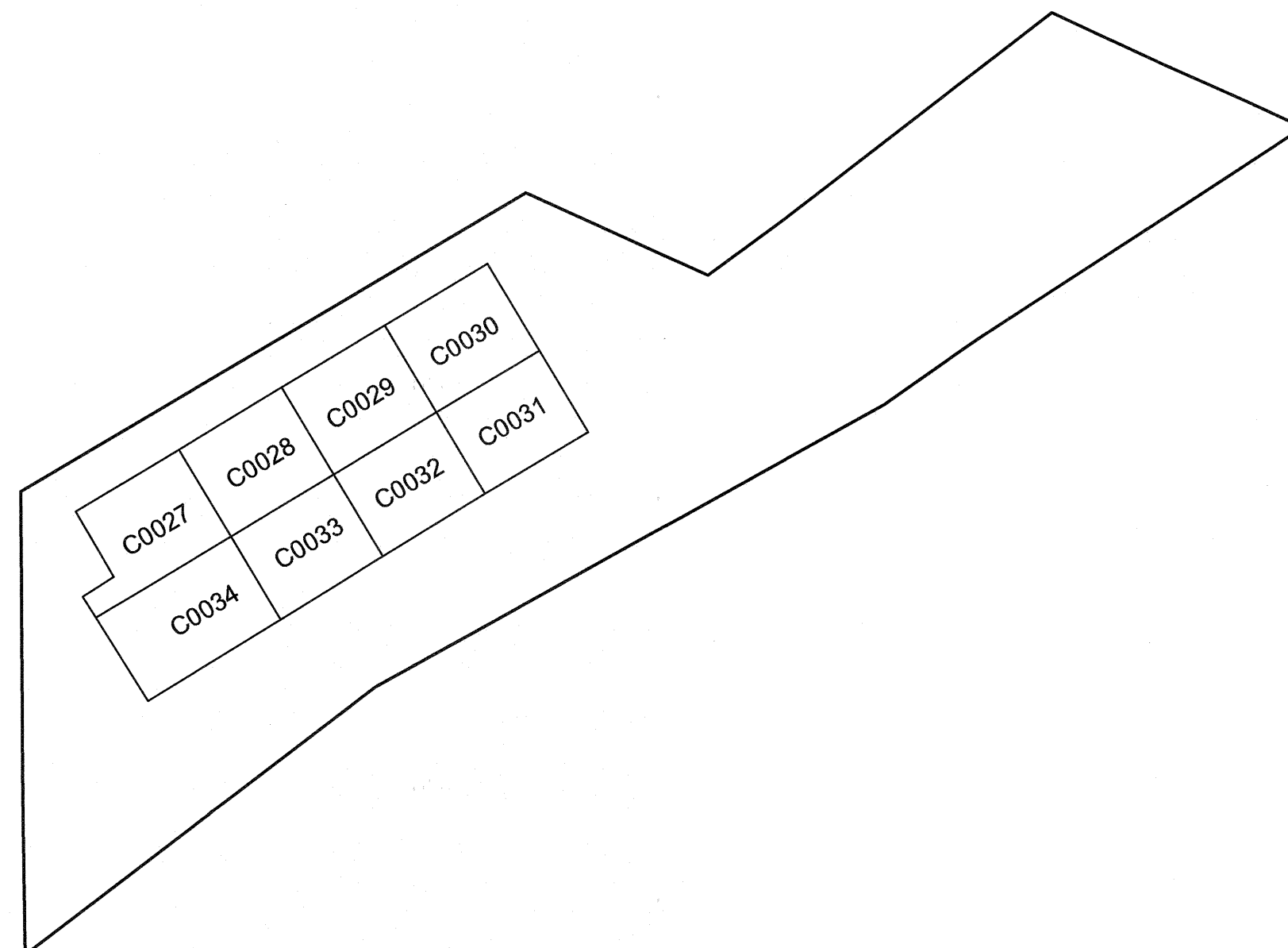

BLOCK	LOT	QUAL	SQ. FT.	FLOOR	UNIT NO.
		C0001	990	1	A1
		C0002	964	1	A2
		C0003	964	1	A3
		C0004	964	1	A4
		C0005	836	1	A5
		C0006	1,055	1	A6
		C0007	991	2	B1
		C0008	964	2	B2
		C0009	964	2	B3
		C0010	964	2	B4
		C0011	836	2	B5
		C0012	1,055	2	B6
		C0013	946	2	B7
		C0014	910	2	B8
		C0015	910	2	B9
		C0016	946	2	B10
		C0017	991	3	C1
		C0018	964	3	C2
		C0019	964	3	C3
		C0020	964	3	C4
		C0021	836	3	C5
		C0022	1,055	3	C6
		C0023	946	3	C7
		C0024	910	3	C8
		C0025	910	3	C9
		C0026	946	3	C10
		C0027	991	4	D1
		C0028	964	4	D2
		C0029	964	4	D3
		C0030	964	4	D4
		C0031	946	4	D7
		C0032	910	4	D8
		C0033	910	4	D9
		C0034	946	4	D10

THIS MAP HAS BEEN DRAWN USING COMPUTER AIDED DRAFTING/DESIGN (CAD/D)

NEW JERSEY DEPARTMENT OF THE TREASURY
 DIVISION OF TAXATION
 APPROVED AS A TAX MAP PURSUANT TO THE AUTHORITY OF
 N.J.S.A. 52:18 AND N.J.S.A. 52:27
 FOR THE DIRECTOR, DIVISION OF TAXATION



DATE MAR 31 2022 SERIAL NO. 1129

TAX MAP
CITY OF ELIZABETH
 UNION COUNTY NEW JERSEY
 SCALE: 1" = 50' FEB. 15, 2019
GLEN J. LLOYD
 N.J. PROFESSIONAL LAND SURVEYOR LIC. #GS037598
 MASER CONSULTING PA
 331 NEWMAN SPRINGS ROAD, SUITE 203
 RED BANK, NJ 07701