

REVISIONS		
DATE	NAME	LIC. NO.

KEY SHEET 2

KEY SHEET 6



KEY SHEET 1

AMTRK (FORMERLY U.N.J.R.R. & C. CO.) TRENTON TO JERSEY CITY MAIN LINE

LEGEND

- STATE BOUNDARY LINE
- COUNTY BOUNDARY LINE
- MUNICIPAL BOUNDARY LINE
- SHEET LIMIT LINE
- BLOCK LIMIT LINE
- 01 DETAIL SHEET NUMBERS ON KEY MAP
- 973 BLOCK NUMBERS ON KEY MAP

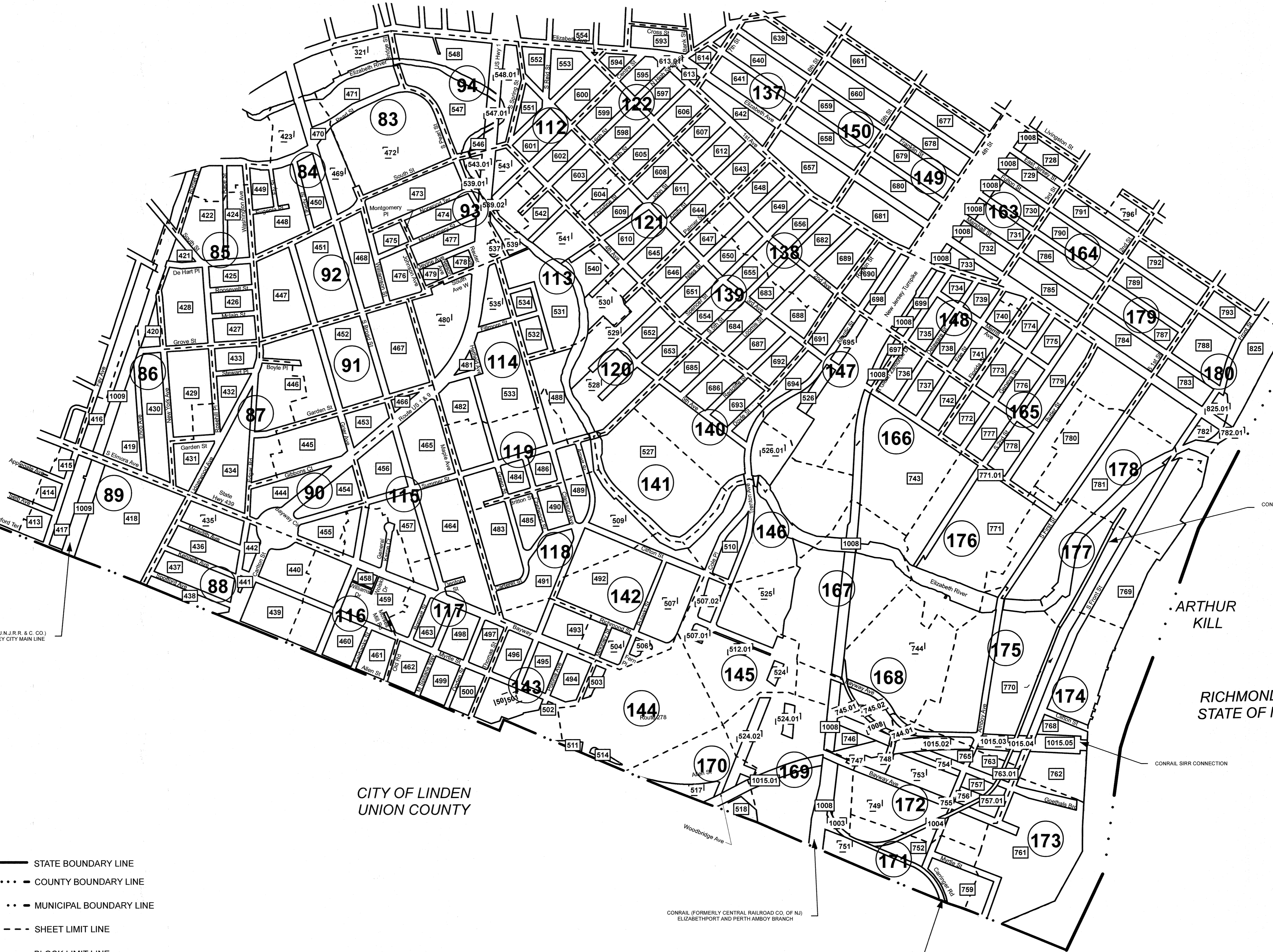

CITY OF LINDEN
UNION COUNTY

ARTHUR KILL
RICHMOND COUNTY
STATE OF NEW YORK

CONRAIL (FORMERLY CENTRAL RAILROAD CO. OF NJ) ELIZABETHPORT AND PERTH AMBOY BRANCH

NEW JERSEY DEPARTMENT OF THE TREASURY
DIVISION OF TAXATION
APPROVED AS A TAX MAP PURSUANT TO THE AUTHORITY OF
N.J.S.A. 8C:1-18 AND N.J.S.A. 8C:2-1
FOR THE DIRECTOR, DIVISION OF TAXATION



DATE MAR 31 2022 SERIAL NO. 1129

TAX MAP
CITY OF ELIZABETH
 UNION COUNTY NEW JERSEY
 SCALE: 1" = 500' FEB. 15, 2019
GLEN J. LLOYD
 N.J. PROFESSIONAL LAND SURVEYOR LIC. #GS037598
 MASER CONSULTING PA
 331 NEWMAN SPRINGS ROAD, SUITE 203
 RED BANK, NJ 07701

THIS MAP HAS BEEN DRAWN USING COMPUTER AIDED DRAFTING/DESIGN (CAD/D)